

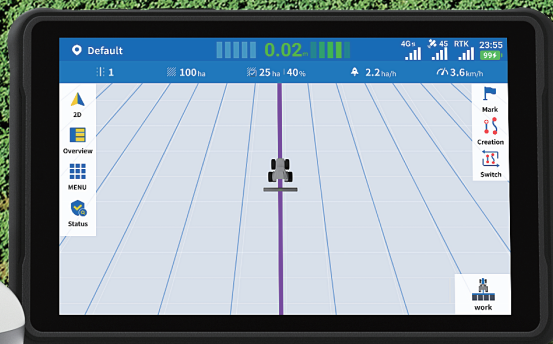

Sveaverken F100G Guidance System

Easy entry into precision farming.



Precise Driving without the Hard Work

The Sveaverken F100G Guidance System offers essential, high-accuracy guidance for agricultural vehicles, providing an accessible entry point to precision farming. With simplified path guidance and operation planning, it reduces driver fatigue while keeping your vehicle on course, even in challenging terrain.

It may be hard for human operators to control their vehicles accurately and consistently when they till, plant, spray, and harvest, especially during long hours or harsh weather. Driving manually often results in overlaps or gaps, increasing costs and reducing yields. The Sveaverken F100G helps operators of all skill levels work precisely and efficiently.



Maximize Every Seed

Optimized routes, better efficiency. Plan and execute precise driving routes to ensure every inch of the field is utilized, reducing waste and maximizing returns.

Remove the Guesswork

Real-time feedback and automated guidance allow the F100G to lighten a driver's workload, allowing them to stay focused and productive for longer hours.

High Precision

The F100G supports multiple GNSS correction services, delivering reliable and accurate navigation, no matter where you work.

Simple Setup for Quick Installation

With Sveaverken's wireless connection between the guidance terminal and GNSS receiver, the F100G eliminates complex wiring, making setup quick and easy.

Key Features

Flexible GNSS Correction Solutions

With advanced correction service, the F100G ensures evenly spaced rows during field operations for precise application, maximizing yields and minimizing overlaps.

5-10 cm accuracy

Precise point positioning (PPP): Free 5-10cm accuracy without network access.

2.5 cm accuracy

RTK: Network or base station needed

20-50 cm accuracy

SBAS: without network access or base station. GPS (US), GLONASS (RUS), Galileo (EU), BDS (CN) supported.

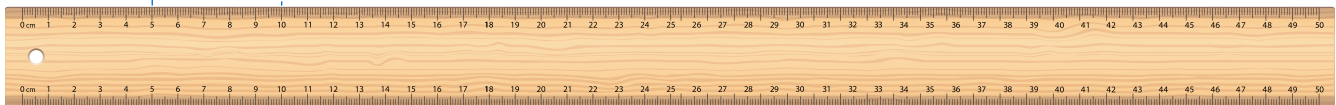

No Wires Needed

The F100G's guidance terminal communicates with the GNSS receiver via WiFi, so that's one less wire to set up from the roof of your tractor to the cabin.



Easy Path Planning

Start by selecting a guidance line that best suits your task and field shape, ensuring your vehicle stays on track from start to finish.

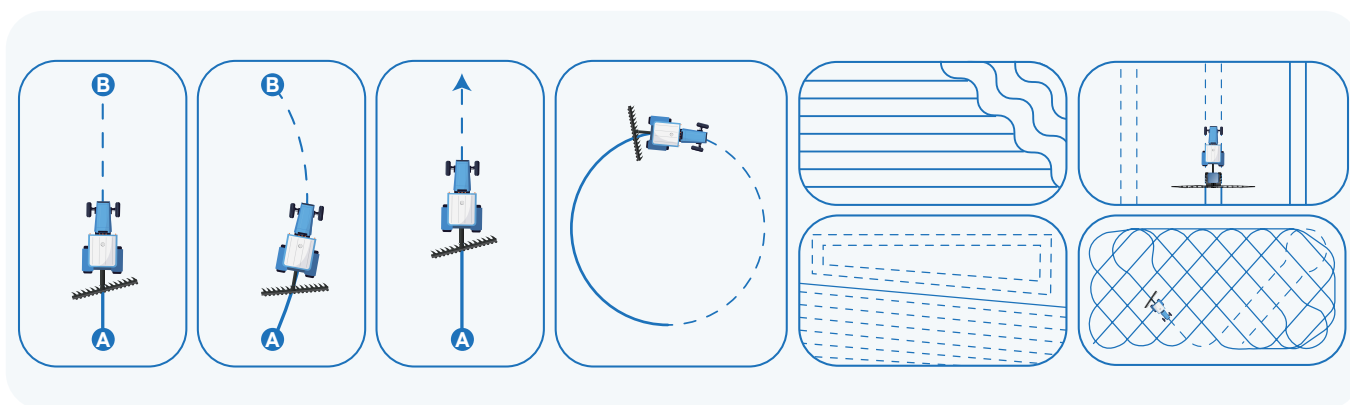

Know More About Your Field

Create profiles for each field, recording boundaries, guidance lines, and completed tasks. Use historical data to plan future work, track progress, and make informed decisions for planting, spraying, and harvesting.



Adjustable Guidance Lines

Adjust guidance lines to fit your tasks, reducing the need for constant reconfiguration. Sync guidance lines between tractors to ensure smooth, coordinated operations in the same field.



Guidance Line Translation



Guidance Line Sync



Guidance Line Scaling

Stay on Track with Real-Time Monitoring

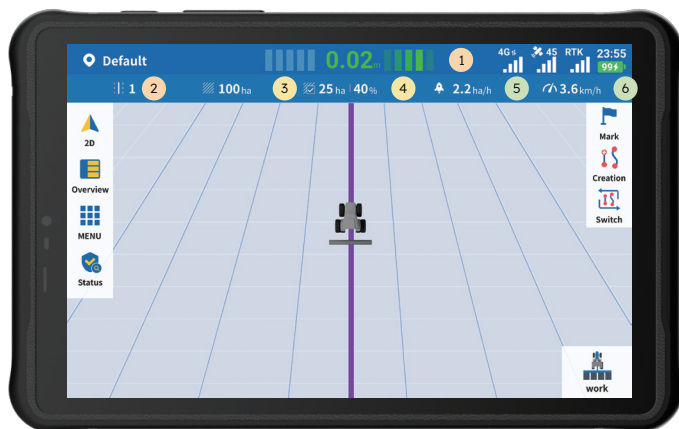

The F100G monitors vehicle alignment, detecting deviations from the pre-set path and signaling the terminal display. With real-time feedback, drivers can make quick adjustments to keep the vehicle on course.

- 1 Offset Values
- 2 Guidance Line Number
- 3 Field Area
- 4 Operation Area | Completion Rate
- 5 Operation Efficiency
- 6 Speed

Specifications

Control Terminal

Size	211.5 mm×136.0 mm×16.3 mm
Screen Display	10-inch, IPS 1280×800
Operation Temperature	-20-55°C
Storage Temperature	-40-70°C
Protection Level	IP 65

GNSS Receiver

Correction Source	GPS L1/L2/L5, GLONASS L1/L2, BDS B1/B2/B3, Galileo E1/E5, SBAS
Operation Voltage	9-36V
Size	162 × 78mm
Operation Temperature	-20-70°C
Storage Temperature	-40-85°C
Protection Level	IP 67



Sveaverken

Free quote: sales@sveaverken.com

Follow us on social media [f](#) [in](#) [@](#) [v](#) YouTube

Copyright © Sveaverken Rights Reserved.